

GROUP 9 DIN RAIL

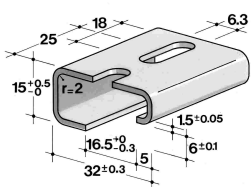

DIN rail	Item	N° holes	Weight/each	Pcs per box
----------	------	----------	-------------	-------------



Cold-rolled steel support guide in accordance with UNI 5961-67 Standards, electrogalvanised with tropical colour. Manufactured in accordance with DIN 46277 sheet 1 and CENELEC-EN 50.035 Standards. It is also available with 18 mm length slotted hole and it is cut in 2.0 m bars.

BENI-200	Without		g 1460	10
BENI-2F	With		g 1380	10

DIN rail	Item	N° holes	Weight/each	Pcs per box
----------	------	----------	-------------	-------------

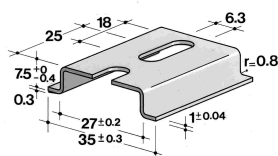

Cold-rolled steel support guide in accordance with UNI 5961-67 Standards, electrogalvanised with tropical colour. Manufactured in accordance with DIN 46277 sheet 3 and CENELEC-EN 50.022 Standards. It is also available with 18 mm length slotted hole and it is cut in 2.0 m bars.

LART-200	Without		g 700	20
LART-2F	With		g 600	20

DIN rail	Item	N° holes	Weight/each	Pcs per box
----------	------	----------	-------------	-------------

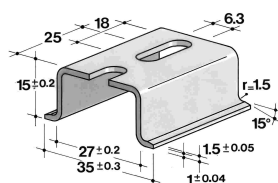

Cold-rolled steel support guide in accordance with UNI 5961-67 Standards, electrogalvanised with tropical colour. Manufacture in accordance with CENELEC-EN 50.022 Standards. It is also available with 18 mm length slotted hole and it is cut in 2.0 m bars.

BRR 35	Without		g 1340	10
BRR 35F	With		g 1230	10

DIN rail	Item	N° holes	Weight/each	Pcs per box
----------	------	----------	-------------	-------------

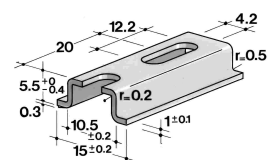

Cold-rolled steel support guide in accordance with UNI 5961-67 Standards, electrogalvanised with tropical colour. Manufacture in accordance with DIN 46277 sheet 2 Standards. It is also available with 12.2 mm length slotted hole and it is cut in 2.0 m bars.

BRR 15	Without		g 330	50
BRR 15F	With		g 280	50

DIN rail	Item	N° holes	mm.	Weight/each	Pcs per box
----------	------	----------	-----	-------------	-------------

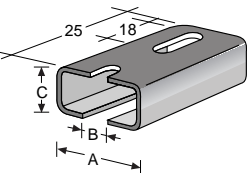

Structural steel, 1.5 mm thickness, electrogalvanised with tropical colour, also available with 18 mm length slotted hole and it is cut in 2.0 m bars.

A x B x C					
BRR 25	Without		25 x 15 x 12	g 1.360	10
BRR 25F	With		25 x 15 x 12	g 1.240	10
BRR 30	Without		30 x 15 x 10	g 1.600	10
BRR 30F	With		30 x 15 x 10	g 1.500	10

Support bracket	Item	Weight/each	Pcs per box
-----------------	------	-------------	-------------

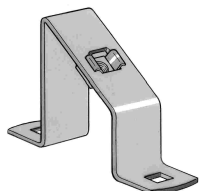

Galvanized steel support bracket yellow passivated with 6MA threaded hole.

SBP		g 48	50