

GROUP 6 ACCESSORIES FOR EQUIPOTENTIAL CONNECTIONS

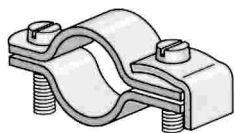

Galvanised steel collar	Item	ø in mm	ø in inches	Weight/each	Pcs per box
-------------------------	------	---------	-------------	-------------	-------------



Galvanised steel collar equipped with two screws, appropriate for pipe earthing. (Connecting wire max section 16 mm²).
 In accordance with IEC Standards

CMT16	16-18	3/8"	g 37	125
CMT19	19-22	1/2"	g 39	100
CMT25	25-28	3/4"	g 45	75
CMT31	31-36	1"	g 48	50
CMT38	38-43	1 1/4"	g 55	40
CMT48	48-50	1 1/2"	g 62	30
CMT58	50-62	2"	g 68	20

Copper collar	Item	ø in mm	ø in inches	Weight/each	Pcs per box
---------------	------	---------	-------------	-------------	-------------

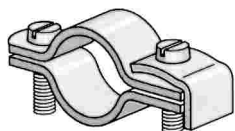

Copper collar equipped with stainless steel screws, appropriate for pipe earthing. (Connecting wire max section 16 mm²).

CMTR16	16-18	3/8"	g 37	125
CMTR19	19-22	1/2"	g 39	100
CMTR25	25-28	3/4"	g 45	75
CMTR31	31-36	1"	g 48	50
CMTR38	38-43	1 1/4"	g 55	40
CMTR48	48-50	1 1/2"	g 62	30
CMTR58	50-62	2"	g 68	20

Available on request

Stainless steel clamp	Item	ø in inches	Weight/each	Pcs per box
-----------------------	------	-------------	-------------	-------------

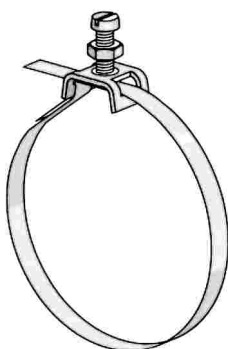

Clamp with stainless steel strip appropriate for pipe earthing, from 3/8" to 2", with 4MA stainless steel contact screws. (Connecting wire max section 6 mm²).
 In accordance with IEC Standards

FO 6	da 3/8 a 2"	g 11	100
------	-------------	------	-----

GROUP 6 ACCESSORIES FOR EQUIPOTENTIAL CONNECTIONS



Tinned copper earthing plait	Item	Material	Sect. mm ²	∅ holes in mm	Total length mm	Weight per	Pcs per box
------------------------------	------	----------	-----------------------	---------------	-----------------	------------	-------------



Earthing plait for flexible connection.
In accordance with IEC Standards

TR1015S	tinned copper	10	9	150	g 19	50
TR1020S	tinned copper	10	9	200	g 24	50
TR1615S	tinned copper	16	9	150	g 27	50
TR1620S	tinned copper	16	9	200	g 33	50
TR1625S	tinned copper	16	9	250	g 40	50
TR2515S	tinned copper	25	9	150	g 44	50
TR2520S	tinned copper	25	9	200	g 55	50
TR2525S	tinned copper	25	9	250	g 67	50
TR2530S	tinned copper	25	9	300	g 81	50
TR3520S	tinned copper	35	9	200	g 85	25
TR3525S	tinned copper	35	9	250	g 104	25
TR5025S	tinned copper	50	11	250	g 142	25

Sectioning equipotential point	Item	Weight/each	Pcs per box
--------------------------------	------	-------------	-------------

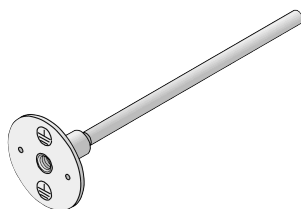

Sectioning equipotential point, measure or connection of earthing connectors to the reinforcing rods. Galvanised steel plate with 10 MA central threaded hole.

NE10	g 350	10

U-clamp	Item	Sections	Weight/each	Pcs per box
---------	------	----------	-------------	-------------

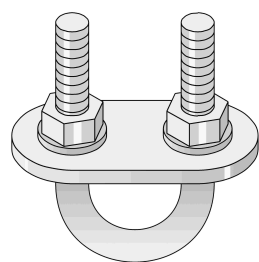

Galvanised steel U-clamp appropriate to connect round or orthogonal iron or cables.

MC12	8÷12 + 8÷12	g 50	100
MC16	14÷16 + 14÷16	g 55	100
MC22	20÷22 + 20÷22	g 65	100

Zamak collar for pipes	Item	∅ in inches	Weight/each	Pcs per box
------------------------	------	-------------	-------------	-------------

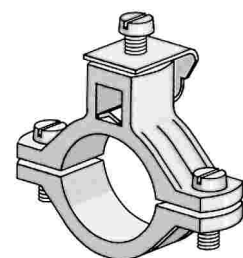

Zamak collar for pipe earthing. For conductors up to max. 25 mm².
In accordance with IEC Standards

CO 2	3/8"	g 65	10
CO 3	1/2"	g 70	10
CO 4	3/4"	g 80	10
CO 5	1"	g 86	10
CO 6	1 1/4"	g 95	10
CO 7	1 1/2"	g 110	10
CO 9	1 3/4"	g 120	10
CO 8	2"	g 127	10

GROUP 6 ACCESSORIES FOR EQUIPOTENTIAL CONNECTIONS

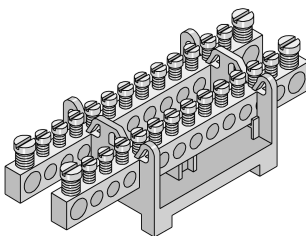

Terminal board for equipotential connections	Item	Rated sect.	Wire sect. in mm ²	N° of cables solid	N° of cables flexible	ø holes in mm	Pcs per box
 <p>Terminal board with support for horizontal snap fitting on guide DIN EN 50022, made of polyamide, with brass bar and galvanised steel screws appropriate for equipotential connections. In accordance with IEC Standards</p>	PCE5	7x16 mm ²	1,5-16	7	7	7 x ø6	4
		1 bar of 7					
	PCE6	14x16 mm ²	1,5-16	14	14	14 x ø6	4
		2 bars of 7					
	PCE7	24x16 mm ²	1,5-16	24	24	24 x ø6	2
		4x25 mm ²	4-25	4	4	4 x ø7,5	
		2 bars of 14					

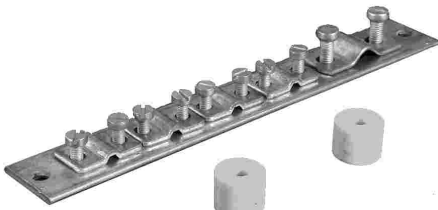
Terminal board for equipotential connections	Item	Connecting wires	Weight/each	Pcs per box
 <p>Copper terminal board for equipotential connections with section 30 x 3 mm. Length: 200 mm Stainless steel screws</p>	PCE8	1 of 35 ÷ 50 mm ²	Kg 0,235	1
		4 of max 35 mm ²		



Terminal board for equipotential connections	Item	Connecting wires	Weight/each	Pcs per box
 <p>Copper terminal board for equipotential connections with section 50 x 4 mm. Length: 250 mm Stainless steel screws</p>	PCE9	1 of 50÷120 mm ²	Kg 0,600	1
		3 of 35÷150 mm ²		
		5 of max 35 mm ²		

Plate for equipotential connections	Item	Holes	Weight/each	Pcs per box
 <p>Tinned copper plate for equipotential connections with section 100 x 8 mm. Length: 250 mm</p>	PCE10	n. 8 of ø 13	Kg 1,170	1

GROUP 6 ACCESSORIES FOR EQUIPOTENTIAL CONNECTIONS



Plates for equipotential connections	Item	Connecting wires	Weight/each	Pcs per box
--------------------------------------	------	------------------	-------------	-------------

Copper plate for equipotential connections with section 60 x 5 mm.
Length: 240 mm
Provided with coppered stainless steel screws.

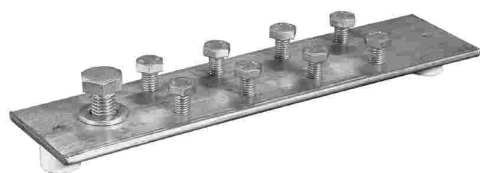

PCE11	n. 1 of 12 MA	Kg 0,750	1
	n. 8 of 8 MA		

Plate for equipotential connections	Item	Holes	Material	Weight/each	Pcs per box
-------------------------------------	------	-------	----------	-------------	-------------

Plate for equipotential connections.
Section: 40 x 5 mm.
Length: 280 mm



PCE12	n°8 of ø 13	hot-galvanised	Kg 0,430	1
PCE13	n°8 of ø 13	stainless steel	Kg 0,430	1

Plate for equipotential connections	Item	Holes	Material	Weight/each	Pcs per box
-------------------------------------	------	-------	----------	-------------	-------------

Plate for equipotential connections.
Section: 50 x 5 mm.
Length: 280 mm



PCE14	n°14 of ø 13	hot-galvanised	Kg 0,500	1
PCE15	n°14 of ø 13	stainless steel	Kg 0,500	1

Anchor square	Item	Weight/each	Pcs per box
---------------	------	-------------	-------------

Hot-galvanised anchor square for PCE 12 ÷ PCE15 items with anchoring holes Ø 13 mm.
Section: 40x 3 mm

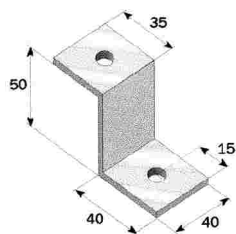

PCE16		Kg 0,100	10

GROUP 6 ACCESSORIES FOR EQUIPOTENTIAL CONNECTIONS



Terminal board for equipotential connections	Item	Weight/each	Pcs per box
--	------	-------------	-------------

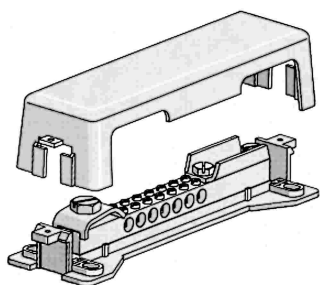

Nickel plated brass terminal board for equipotential connections.
Possible connections:
- 7 protective wires with 16 mm² max. sect.
- 1 wire with min. Ø 7 mm or max. Ø 10 mm
- 1 flat wire max. 30 x 4 mm
In accordance with IEC Standards

PCE1		g 292	6

Terminal board for equipotential connections	Item	Weight/each	Pcs per box
--	------	-------------	-------------

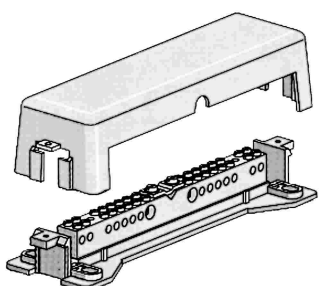

Nickel plated brass terminal board appropriate for equipotential connections in special environments. Base with plastic cover.
Possible connections:
- 14 wires with 6 mm² max. sect.
- 3 wires with 25 mm² max. sect.
In accordance with IEC Standards

PCE2		g 266	6

Terminal board for equipotential connections	Item	Weight/each	Pcs per box
--	------	-------------	-------------



Terminal board appropriate for equipotential with a hinged cover which can be sealed with lead on one side.
Possible connections:
- 1 flat wire max. 30 x 4 mm or 1 round wire of Ø 7-10 mm
- 6 round wires with 6 – 25 mm².
- 1 round wire with Ø 8 - 10 mm or 50 mm².
In accordance with IEC Standards

PCE3		g 160	10

Terminal board for equipotential connections	Item	Brass bar side			Copper plate side		Weight/each	Pcs per box
		Ø holes/	wire sect		primary wires	dimen.		
		Ø 5,3	Ø 6,9	Ø 8,2	round bar	metal strap		
		1,5/10	6/16	16/35	Ø mm	max mm		
		mm ²	mm ²	mm ²				

PCE18	n° 5	n°1	n°1	6-8-10	40x4	g 150	1
PCE19	n°9	n°1	n°1	6-8-10	40x4	g 190	1
PCE20	n°13	n°1	n°1	6-8-10	40x4	g 240	1

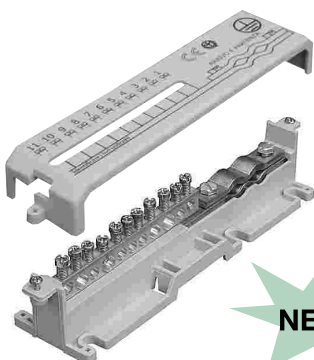

Equipotential terminal board with 7, 11, 15 holes brass bar and copper plate for primary through or terminal wires.
Possibility to fix on DIN 50022 guide.

